

INSTALLATION INSTRUCTIONS
DESCRIPTION: Enduro Skid Plate Kit
PART NUMBER B3J-F14B0-T0
MODEL: '18~ YZ450F



⚠ WARNING

Please read and understand these instructions completely before installation to avoid possible injury, or damage to the accessory or vehicle.

WARRANTY INFORMATION:

In the United States, see your authorized Yamaha dealer for a copy of the Yamaha Genuine Parts and Accessories Limited Warranty.

DEALER OR INSTALLER:

These instructions contain important information for future reference and *must* be given to the customer.

PARTS LIST:

Item #	Part Number	Description	Qty
--	B3J-F14B0-T0	Enduro Skid Plate Kit	--
①	*	Skid Plate	1
②	*	M6 x 20mm Hex Head Flange Bolt	2
③	*	M6 x 16mm Hex Head Flange Bolt	1

* Part supplied with kit only and not available separately.

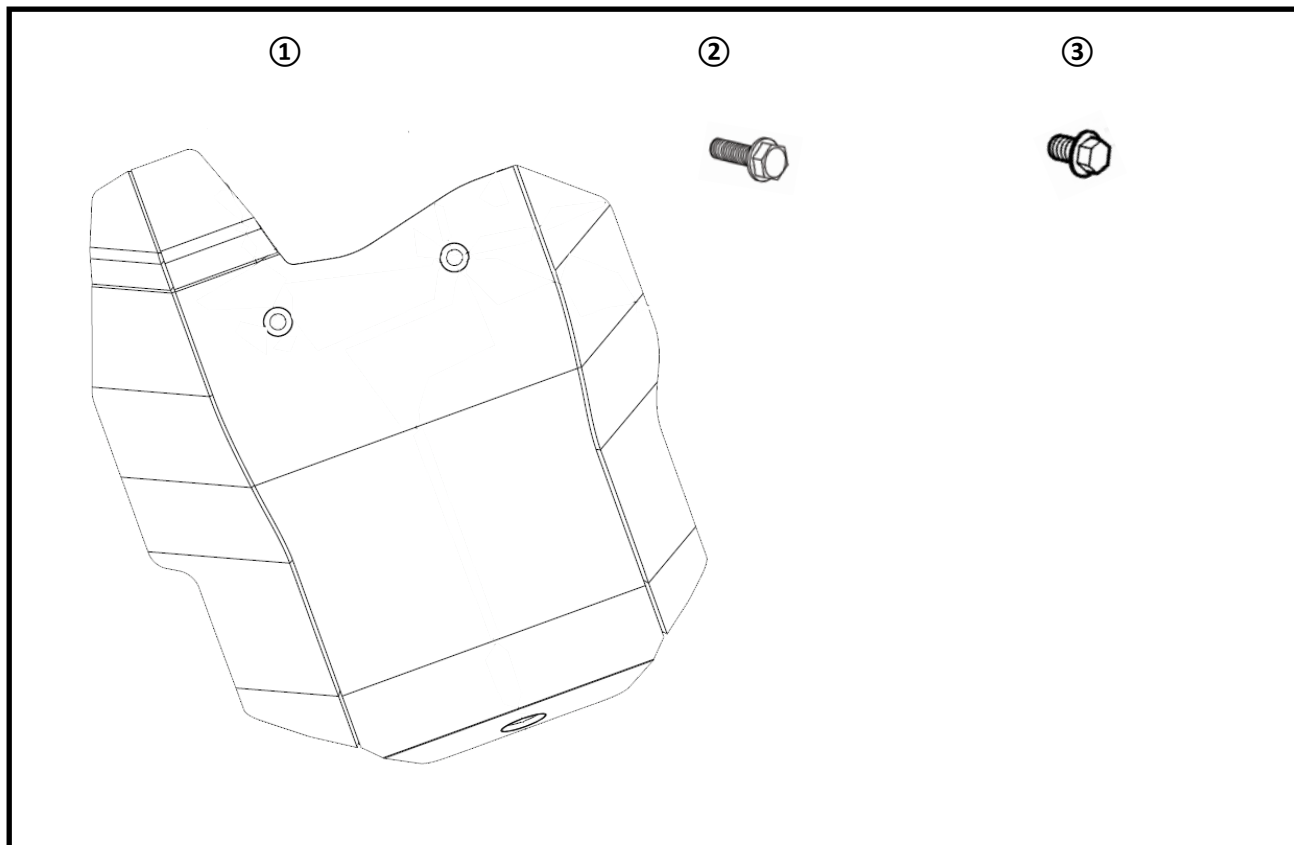

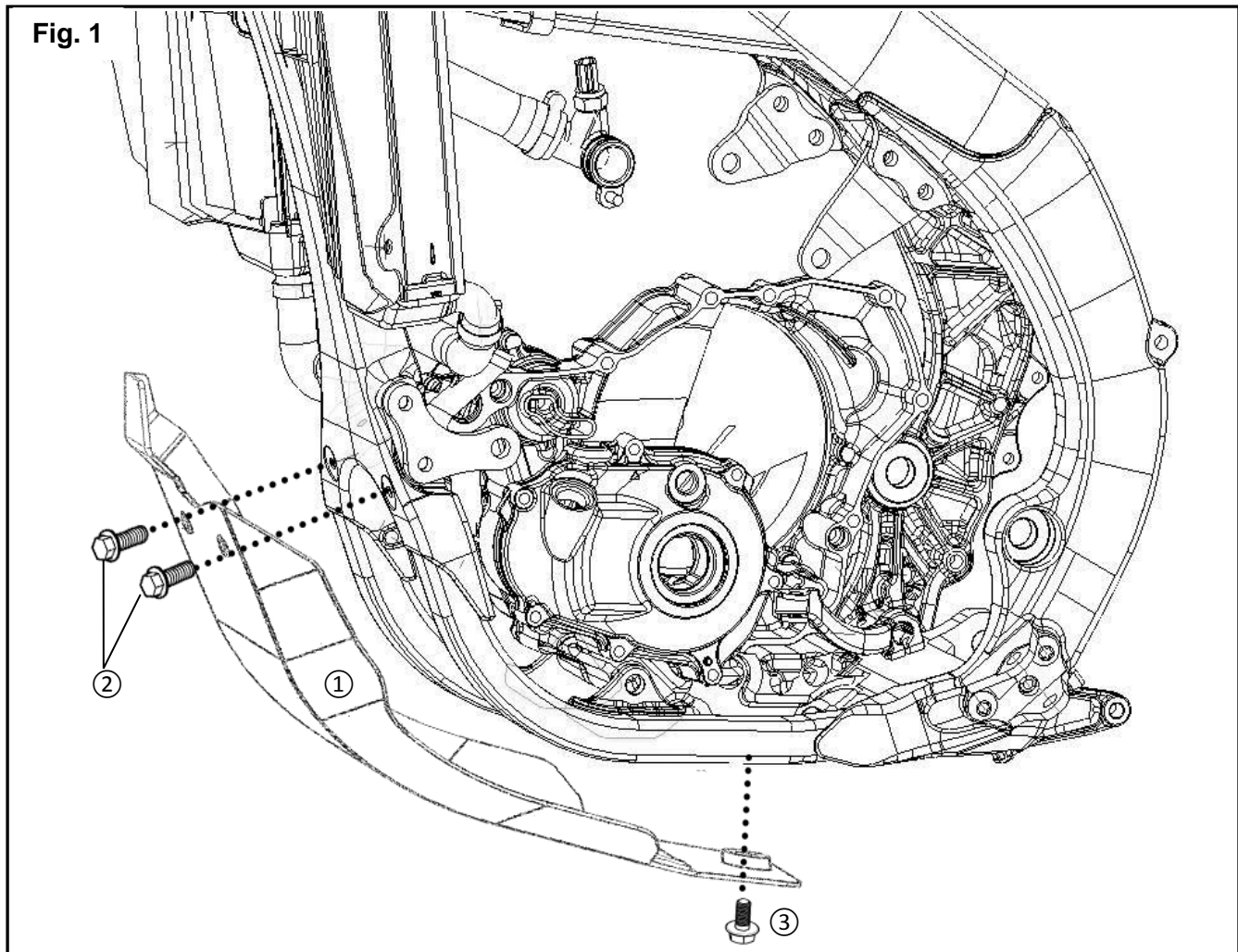

PREPARATION:

- Place motorcycle on a secure and level surface.
- Clean all mounting surfaces before beginning installation.

INSTALLATION:

1. Remove the stock glide plate. None of the stock parts are reused.
2. Fit ① glide plate up to frame and install 2 ② M6x20 Flange Bolts into the upper skid plate holes and keep loose at this time.
3. Pass the ③ M6x16mm Flange Bolt through the glide plate and into the threaded hole in the frame, as shown in Fig. 1.
4. Torque the 3 M6 flange bolts to 5.5 Nm (0.6 m • kgf, 4.1 ft • lbf).

MAINTENANCE:

Periodically check all hardware for tightness and re-torque as required.

CARE AND CLEANING:

Wash using a mild soap and water solution and soft cloth.

CUSTOMER SERVICE:

For further information see your Yamaha dealer.

ESTIMATED TIME TO INSTALL: 0.2 HRS